



Sunlight-Visible. Direct-Replacement. Energy-Efficient. 8" (200mm) 12VDC Type 1 LED Traffic Light Balls (TrafficLED™)



Features

- Major Energy Savings
- Solid-State, High Shock/Vibration Resistant
- Conforms to Industry Standards
- Five-Year Warranty
- Lens Design Improves Brightness

- Lamps Can be Retrofitted into Existing Traffic Housings
- UV Resistant Polycarbonate Unit Eliminates Dust/Dirt Buildup
- Available in Red, Yellow, Green
- Very Low Power Consumption, Super Intensity

Applications

- Traffic Signal Lights
- Traffic Warning Lights
- Railroad Crossings
- Road Closure Signs
- Tunnel Warning Lights

Red and Green TrafficLEDs meet and exceed ITE and Caltrans Specifications

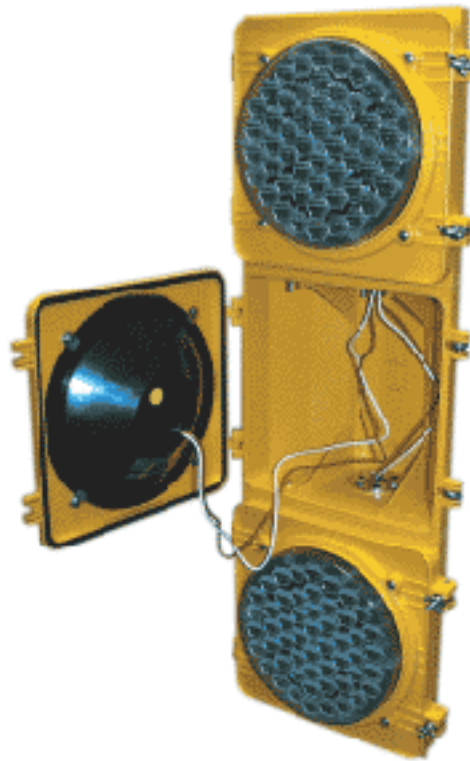

Type 1 connection

Dimensions

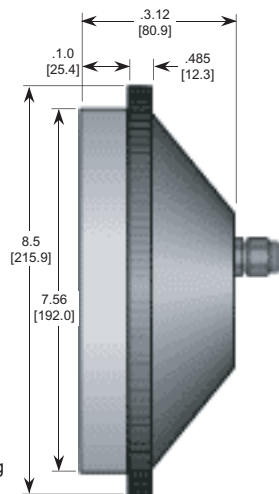

Note: Outer Rubber seal ring supplied with module

Part Number, Type 1	TRF108-0ER-012V	TRF108-0PY-012V	TRF108-0BG-012V
Signal Color	Red	Yellow	Green
Wavelength nm	626	590	505
LED Material	AllnGaP	AllnGaP	InGaN
Lens Material	UV Resistant Polycarbonate		
Intensity	>400cd	>400cd	>700cd
Power Consumption	3W (250mA)	3W (250mA)	5W (416mA)
Power Factor (PF)	>0.9	>0.9	>0.9
Total Harmonic Distortion	20%	20%	20%
IP Rating with housing	IP34	IP34	IP34
IP Rating without housing	IP65	IP65	IP65
Operating Temperature	-40 °C ~ 74 °C	-40 °C ~ 74 °C	-40 °C ~ 74 °C
Signal Diameter	200mm	200mm	200mm
Weight (Module only)	1300g	1300g	1300g
Intensity loss due to single LED failure	4%	4%	4%

